



FORMER PUMP HOUSE CHELFORD ROAD MACCLESFIELD, SK10 3LQ

£235,000
FREEHOLD

Situated on Chelford Road in the Cheshire town of Macclesfield, this exceptional building plot presents a remarkable opportunity for those looking to create a bespoke residential development.

With planning permission already granted for a pair of three-storey, four-bedroom semi-detached houses, this site is primed for construction. Each home is thoughtfully designed to include two bedrooms with ensuite shower rooms, complemented by two additional bedrooms serviced by a family bathroom. The spacious open-plan kitchen, living, and dining area promises a modern lifestyle, perfect for entertaining.

The plot benefits from a long private driveway, while ample parking and gardens provide outdoor space for recreation. Essential services are already connected to the



MELLER SPEAKMAN

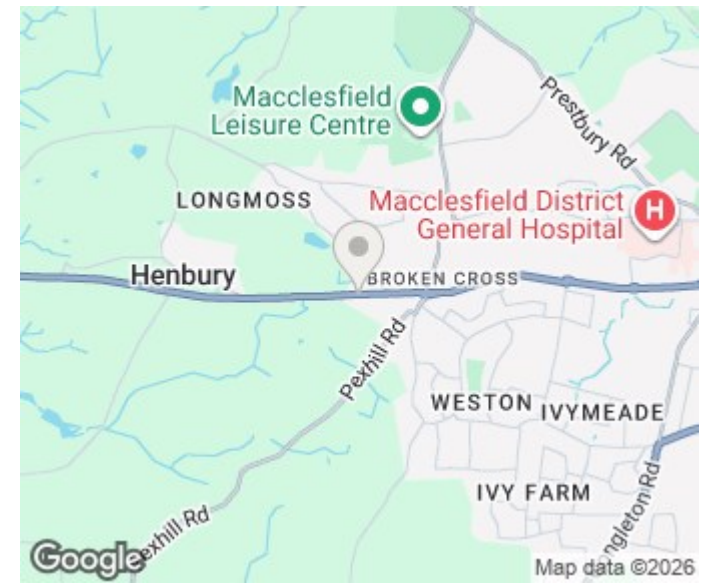
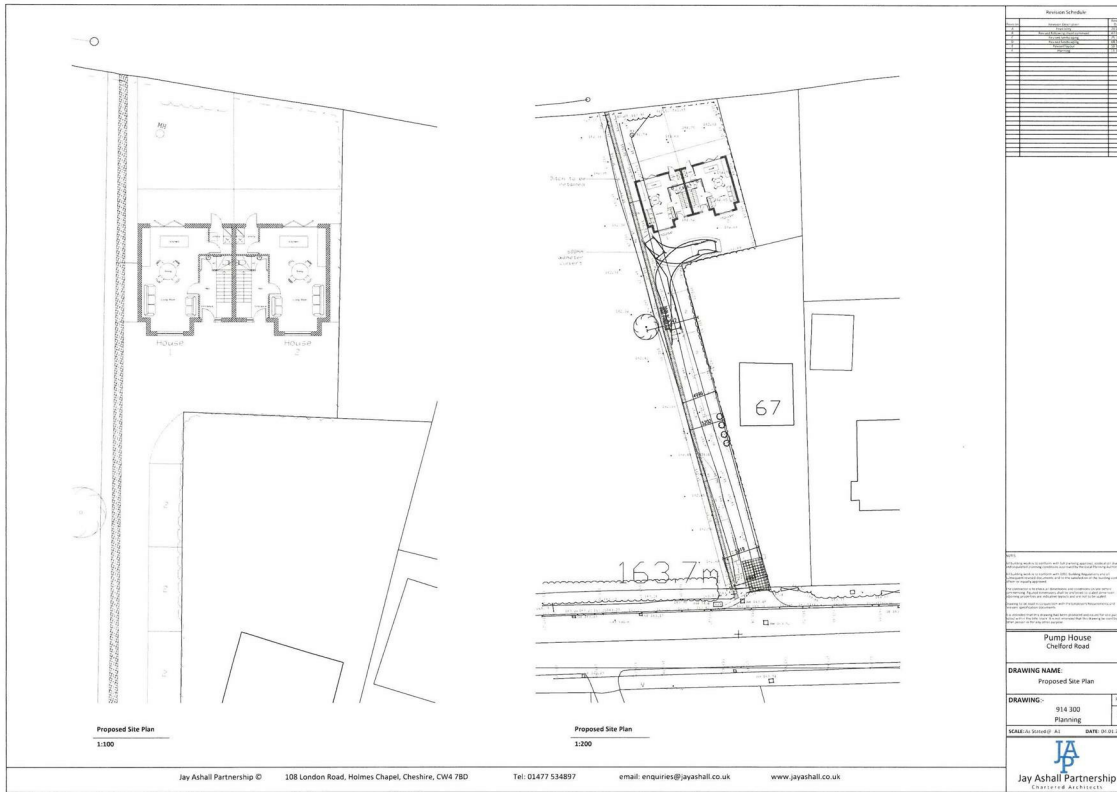

Energy Efficiency Rating		
	Current	Potential
Very energy efficient - lower running costs		
(92 plus) A		
(81-91) B		
(69-80) C		
(55-68) D		
(39-54) E		
(21-38) F		
(1-20) G		
Not energy efficient - higher running costs		
England & Wales	EU Directive 2002/91/EC	

EPC Rating: Council Tax Band: Exempt

Agents Note: Whilst every care has been taken to prepare these particulars, they are for guidance purposes only. All measurements are approximate and are for general guidance purposes only and whilst every care has been taken to ensure their accuracy, they should not be relied upon and potential buyers/tenants are advised to recheck the measurements

Aus Bore House
19-25 Manchester Road
Wilmslow
SK9 1BQ

01625 468789
sales@mellerspeakman.com
mellerspeakman.com



MELLER SPEAKMAN